

**Top of Tank Line, SS**

**Type: 25270/28**

Design meets the requirements of PED 97/23/EC and harmonized standards

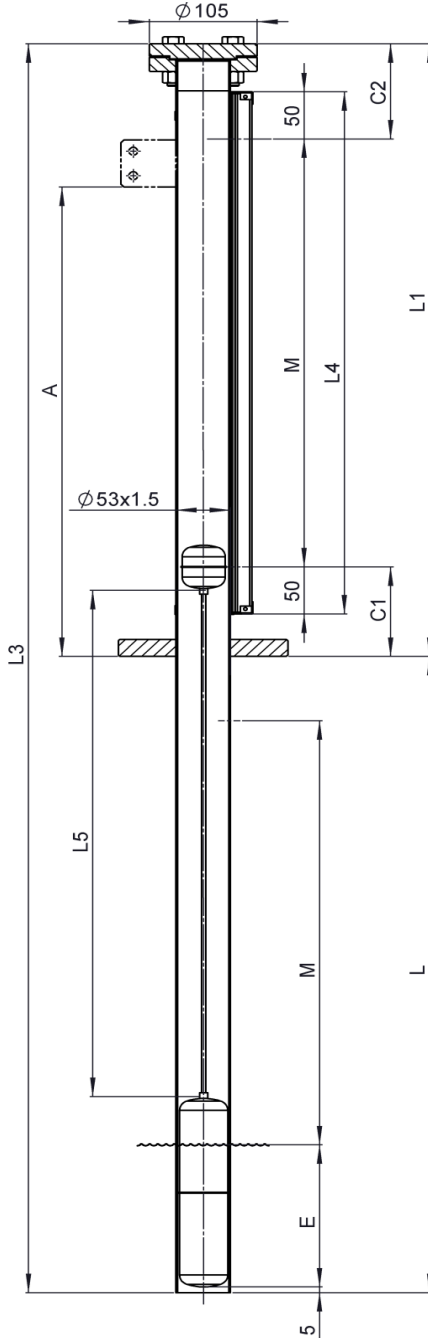

**Purchase Order Data**

Company:  
Purchase order No.:  
Quantity:

Project:  
Tag No.:

**Operating Conditions**

Fluid:  
Density:  $\geq 0.55\text{g/cm}^3$   
Viscosity:  $\leq 600\text{cSt}$   
Operation pressure: max. 28bar(g) @ 20°C \*1  
Design pressure: "  
Operation temperature: -40°C ... +400°C \*1  
Design temperature: "  
Gaskets for top service connection: NBR / PTFE / Graphite

g/cm3:  
cSt:  
bar(g):  
bar(g):  
°C:  
°C:

**Process Connections**

**Process flange EN1092-1:2013**

- EN1092-1/01 A/DN50/PN40/316L  
- Type A : with flat face

**Special flange execution**

Special flange execution

**Process flange ASME B16.5:2013**

- ANSI/ASME B16.5 / 2" class 300 RFSF  
- RF SF: with raised face

**Dimensions**

Tank depth L  
Length L1 (M + 245 mm)  
C1  
C2  
Measuring length M (L - 200 mm)  
Length L4 (M + 100 mm)  
Connection pipe length L5 (L - 140 mm)  
Immersion depth E

	Standard	Special	
0			
95			
150			
0		0	
0		0	
0		0	
-		-	-

**Design and Materials**

Float chamber: 316&316L

Float: -

Magnet holder: -

**Indication Rail**

PC, IP65 (<150°C)  
PC, IP68, inert gas (<150°C)  
Al/PC, IP54 (<250°C)  
Al/Glass, IP54 (<400°C)  
316L, IP67 (<250°C)  
316L, IP67 (<400°C)  
Special execution

Flaps:	No.:	Standard
red-silver	34837	
red-silver	41008	
red-silver	34560	
black-silver	37100	
red-silver	42403	
black-silver	42404	

**Float Extension bottom / top**

C1: 95 C2: 150  
Standard

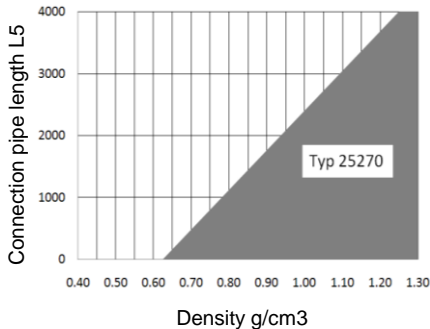

**Accessories (refer to installation instructions 20010501)**

Fixation bracket No. 26936: Dim. "A" [mm]:  
Magnetic switch: Quantity: Type:  
Transmitter: Resolution [mm]: Type:  
Electrical measuring length Mel [mm]:  
Converter: Type:  
Additional accessories:

**Test Reports and Certificates**

EN10204:2004-3.1 Material certificate for float chamber

**Special Executions & Additional Notes**

Special Executions & Additional Notes

**Notes**

\*1) Refer to pressure-temperature rating! Lowest rating of any connecting flange or fitting and float chamber sets the limitation. The test pressure PT is specified acc. to WEKA specifications AW 2.1.2.

All mentioned dimensions are in mm and are valid only for ToT standard executions.

## Pressure-temperature rating for Top of Tank Line SS 25270/28

Max. 28bar(g)@20°C, up to max. 500°C for ToT float chambers in SS EN 1.4401, 1.4436 & 1.4404, 1.4435 resp. ANSI 316&316L

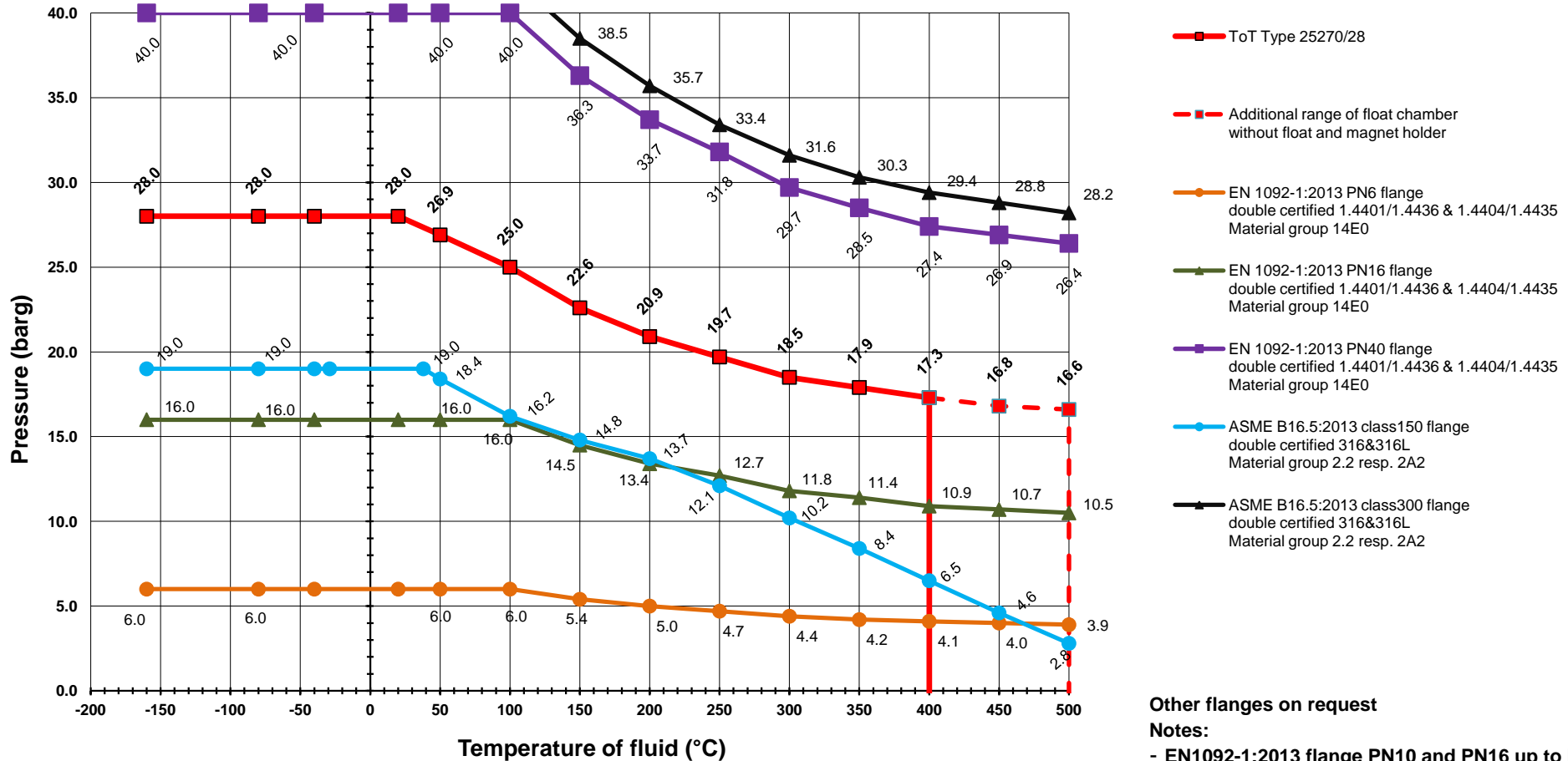

### Other flanges on request

#### Notes:

- EN1092-1:2013 flange PN10 and PN16 up to DN150 use identical interface dimensions
- EN1092-1:2013 flange PN25 and PN40 up to DN150 use identical interface dimensions
- Tolerated max. pressure @ specified temperature for the ToT is given either by the float chamber or by the process flange
- Lower value sets the limitation! ---

